

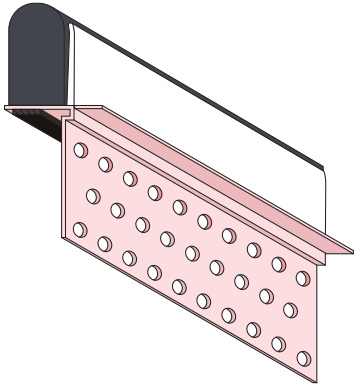

MarinoWARE® HOTROD® XL is a surface mounted fire-rated deflection bead tested to UL 2079. It provides 1 hr and 2 hr firestop solutions in joints for both standard wall and shaft wall types between flat concrete or fluted metal deck applications. It is sound tested according to ASTM E90. Sound Reports available upon request.



- ♥ Tested with up to 80% compression and 30% extension
- ♥ Combines compressible foam, a vinyl concealment leg, and an intumescent strip to provide an aesthetically pleasing joint
- ♥ Provides 1 hr and 2 hr fire ratings from the same profile
- ♥ Provides a single step installation of both a code compliant firestop and finished drywall accessory in one piece
- ♥ Pink perforated mud leg for ease of inspection
- ♥ Installs on the face of the drywall with a perforated mud leg incorporated to accept joint compound
- ♥ Can be used with sprayless Flute Clips to eliminate need for additional firestop sealant or spray
- ♥ Easily installs using spray adhesive and staples
- ♥ Installs fully cured and is printable
- ♥ Does not have temperature or humidity limits for installation
- ♥ For use in assemblies with STC Ratings up to 68

Ordering / Packaging

Description	Part #	Size	Length	Pcs/Ctn
HOTROD XL	HOTRODXL	1/2" x 3/4"	10'	12

Storage / Warranty

- ♥ When stored indoors and kept dry in the original package, HOTROD XL will provide unlimited shelf life
- ♥ See Firestop Product Warranty for details

ASTM & Code Standards

- ♥ ASTM E-84
- ♥ ASTM E-90
- ♥ ASTM E-1966
- ♥ UL 2079 5th Edition
- ♥ L-Rating (air leakage) testing for compliance with International Building Code (IBC) and Canadian Building Code (CBC)
- ♥ UL listings/approvals include: BW-S-0024; HW-D-0550; HW-D-0554; HW-D-0621; HW-D-0624; HW-D-0625; HW-S-0128; WW-S-0057; WW-S-0094
- ♥ **U.S. Patent No. 9,683,364; 10,184,246; and 10,914,065**

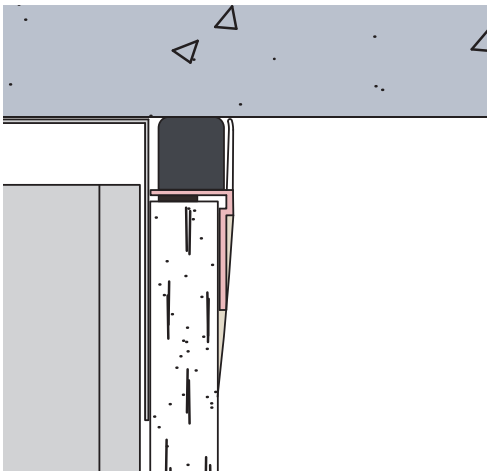

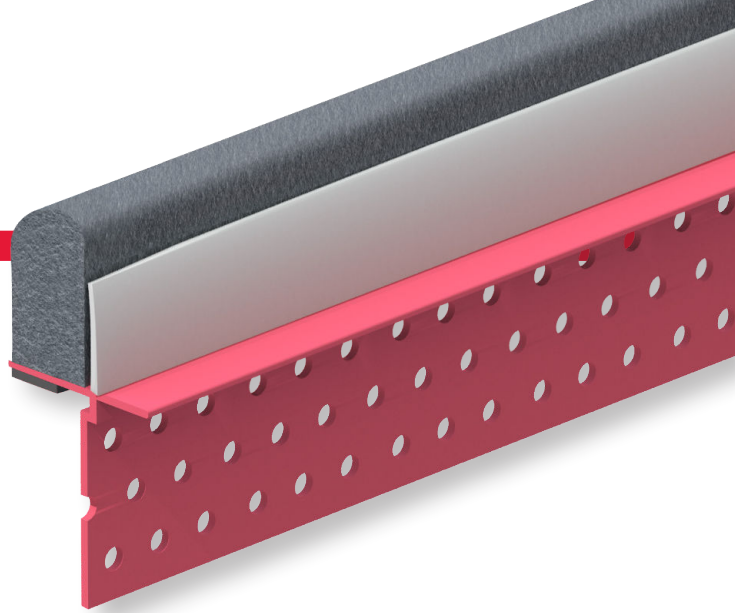

HOTROD® XL

HOTROD® XL is a powerful and versatile fire rated drywall accessory, built to slam the brakes on the passage of smoke, fire and sound. This solution combines a Flat Deflection Bead with compressible foam and intumescent tape for a perfect seal along head-of-wall joints, providing a full 3/4" of building movement.

Installation Guide

Before Installation:

Install drywall no more than 3/4" down from concrete or adjoining structure.

Step 1:

Measure and cut bead to length.

Step 2:

Angle the bead into place and then flatten mud leg against wall while ensuring that the flexible gasket is touching the ceiling/adjacent structure and is slightly compressed. Do not over-compress the flexible gasket or compressible foam.

Step 3:

Staple the mud leg with 1/2" staples every 6-8 inches. (Optional: apply one coat of 847 spray adhesive prior to stapling.) Apply joint compound, and prior to final sanding, remove the tear-off strip for a clean finish.

Notes:

- To keep the drywall gap consistent, use an appropriately sized spacer on top of drywall.
- There should be no gaps left in joints between pieces. Additional sealant may be used at butt joint to ensure seamless joints.

Step 1:

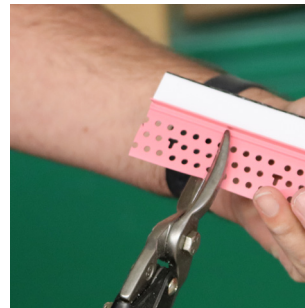

Step 3: (Optional)



Step 2:



Step 3:



Snipped Outside Corners:

Step 1:

Snip through the product's mud leg, mud bump and tear off strip. Do not snip the flexible gasket.

Step 2:

Snip out a 45° triangular section of the product's mud leg on either side of the cut.

Step 3:

Turn the product over. Pull away the compressible foam from the product's return leg and snip out a 45° triangular section of the return leg, intumescent tape, and foam gasket, making sure to align its apex with the previous cut from Step 2.

Step 4:

After completing the required snips, the product should easily bend to form a 90° corner. Ensure no gaps in the intumescent tape.

Step 1:



Step 2:



Step 3:

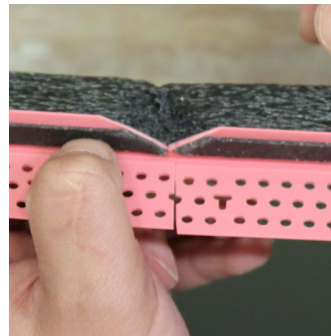

Step 4:



Snipped Inside Corners:

Step 1:

Remove 1" of the tear off strip on the first bead.

Step 2:

Install bead as directed.

Step 3:

Butt second bead into first, forming a tightly fitting inside corner.

Note:

This technique works to form an inside corner even if installing HOTROD® XL on a rated wall and Flat Deflection Bead on a non-rated wall. Please ensure that the HOTROD® XL runs the full length of the rated wall.

Step 1:

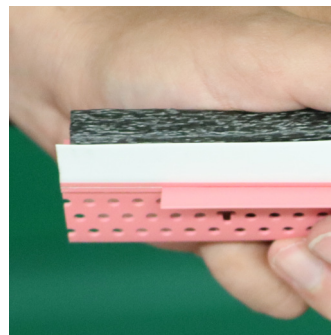

Step 2:



Step 3:

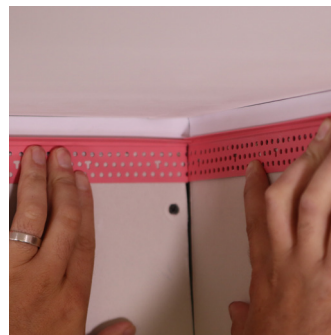

HOTROD® XL

Supplemental Installation Guide

Mitered Inside/Outside Corners:

Step 1:

Use appropriately sized scrap lumber to ensure the product sits flush to the miter fence and perpendicular to the blade.

Step 2:

Make 45° cuts, ensuring that product is oriented properly.

Step 3:

On install, ensure that there are no gaps where intumescent tape meets.

Step 1:

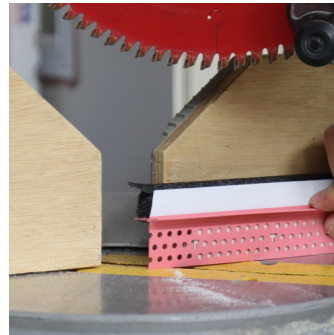

Step 2:

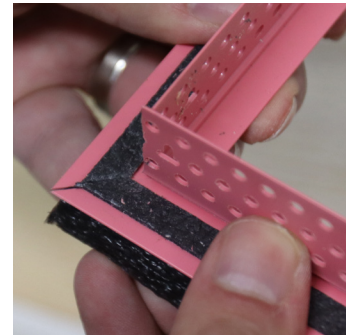

Step 3:



Mitered HOTROD® XL Horizontal to Fire Bead® Vertical Joint:

Step 1:

Use appropriately sized scrap lumber to ensure the product sits flush to the miter fence and perpendicular to the blade.

Step 2:

Make 45° cuts, ensuring that product is oriented properly. Snip an additional 1/8" off of the gasket/foam from the HOTROD® XL, in order to ensure the corners are flush.

Step 3:

On install, ensure that there are no gaps where intumescent tape meets.

Step 1:

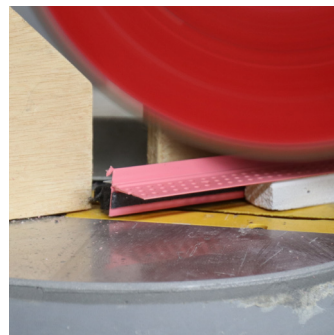

Step 2:

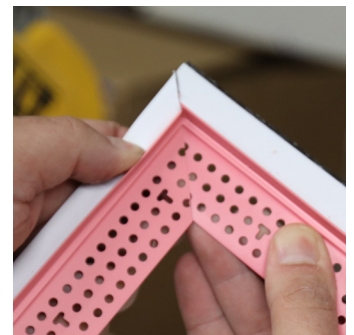

Step 3:



Snipped HOTROD® XL Horizontal to HOTROD® XL Vertical Joint:

Step 1:

Size HOTROD® XL horizontal leg to run wall's full length.

Step 2:

Snip off 1-5/8" of the product's mud leg and mud bump, leaving the flexible gasket, compressible foam and intumescent tape intact.

Step 3:

Remove 1/2" of the tear off strip.

Step 4:

Butt the vertical HOTROD® XL bead into the horizontal HOTROD® XL bead as shown, ensuring there are no gaps where the intumescent tape meets.

Step 1:



Step 2:

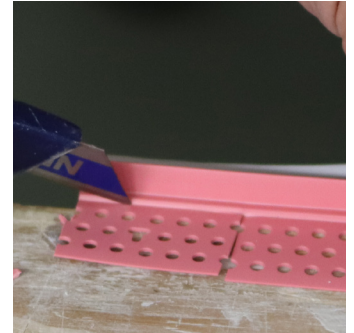

Step 3:



Step 4:

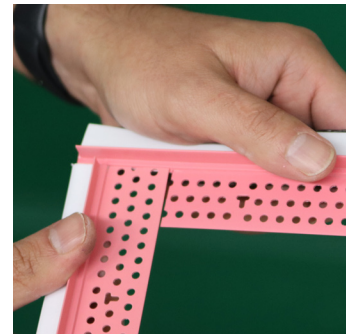

Snipped HOTROD® XL Horizontal to Fire Bead® Vertical Joint:

Step 1:

Size HOTROD® XL horizontal leg to run wall's full length.

Step 2:

Snip off 1-5/8" of the product's mud leg and mud bump, leaving the bubble gasket, compressible foam and intumescent tape intact.

Step 3:

Remove 1/2" of the tear off strip.

Step 4:

Butt the vertical Fire Bead® into the horizontal HOTROD® XL bead as shown, ensuring there are no gaps where the intumescent tape meets.

Step 1:



Step 2:

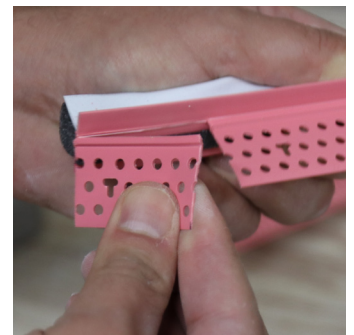

Step 3:

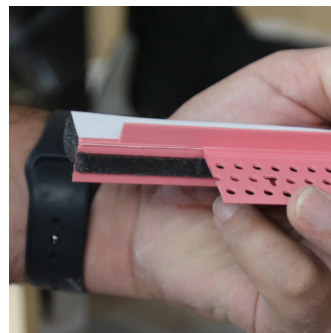

Step 4:

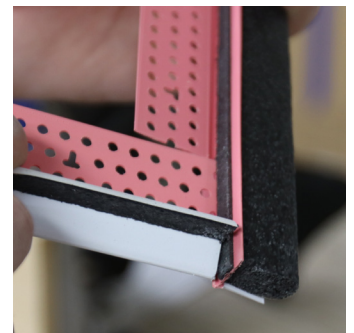

Product	Movement	Standard Wall	Shaft Wall	Fluted Deck	Concrete Deck	Installation	Paintable	Sound Test
Fire Bead FIRE RATED DEFLECTION BEAD	1/4" Comp Only	✓	✓		✓	Post Drywall	✓	✓
Fire Gasket FIRESTOPPING FOR BUILDING JOINTS	FG .5: 1/2" Overall FG 1: 1" Overall FG 1.5: 1-1/2" Overall	✓	✓	✓	✓	Pre Drywall	✓	✓
HOTROD TYPE X FIRESTOPPING FOR BUILDING JOINTS	1/2" Comp 1/4" Ext	✓	✓	✓	✓	Post/Pre Drywall	✓	✓
HOTROD XL FIRESTOPPING FOR BUILDING JOINTS	1/2" Comp 1/4" Ext	✓	✓	✓	✓	Post Drywall	✓	✓
FireRip FIRESTOPPING FOR BUILDING JOINTS	FR2: 2" Overall FR3: 3" Overall	✓	✓	✓	✓	Post Drywall	✓	
FAS[®]-093X™ FAS[®]-093X™-V	15% of 1/2" Joint Width	✓	✓	✓	✓	Post Drywall	✓	✓

Product	UL / Approvals (UL 2079 5th Edition)
Fire Bead FIRE RATED DEFLECTION BEAD	HW-D-0624; HW-D-0625; HW-D-0554; HW-D-0550; BW-S-0024; WW-D-0104
Fire Gasket FIRESTOPPING FOR BUILDING JOINTS	HW-D-0515; HW-D-0514; HW-D-0524; HW-D-0551; HW-D-0550; HW-D-0554; HW-D-0600; HW-D-0620; HW-D-0652; HW-D-0518; HW-D-0553; HW-D-0573 ; HW-D-0623; WW-S-0057; BW-S-0024; WW-D-0104
HOTROD TYPE X FIRESTOPPING FOR BUILDING JOINTS	HW-D-0624; HW-D-0625; HW-D-0554; HW-D-0550; BW-S-0024; WW-D-0104; WW-S-0057; HW-D-0514; HW-D-0518; HW-D-0524; HW-D-0652; HW-D-0620; HW-D-0573; HW-D-0525; HW-D-0553; HW-D-0621; WW-S-0094
HOTROD XL FIRESTOPPING FOR BUILDING JOINTS	HW-D-0624; HW-D-0625; HW-D-0554; HW-D-0550; BW-S-0024; WW-D-0104, HW-D-0514; HW-D-0518; HW-D-0524; HW-D-0652; HW-D-0620; HW-D-0573; HW-D-0525; HW-D-0553; HW-D-0621; WW-S-0094
FireRip FIRESTOPPING FOR BUILDING JOINTS	HW-D-0420; HW-D-0421; HW-D-1096; HW-D-0451; HW-D-0453; HW-D-0461; HW-D-0463; HW-D-0582; HW-D-0584; HW-D-0587; HW-D-0594; HW-D-0602; HW-D-0585
FAS[®]-093X™ FAS[®]-093X™-V	HW-D-0596; HW-D-0621; WW-D-0172

YOUR SUCCESS DEPENDS ON QUALITY BUILDING PRODUCTS AND SO DOES OURS.

For over 30 years, Marino\WARE[®], a division of Ware Industries Inc., has served our customers with top quality cold-formed steel framing products, while delivering better solutions to design and construction challenges. We are committed to providing a superior customer experience through a vast selection of readily available products, a knowledgeable sales team, comprehensive technical support and services, prompt delivery through our fleet of trucks, and an extensive distribution network.

Our best-in-class product development team delivers innovative solutions to installation and cost challenges with products designed to save time, labor, and materials. In addition, we utilize the latest in roll forming techniques, maintain the latest level of technology available to the steel framing industry, and strictly adhere to all ASTM specifications.

Marino\WARE is 100% American-owned and operated. We take pride in creating local jobs, supporting local communities, and manufacturing products that reflect the uncompromising skill and ethics of our professional team. We operate state-of-the-art production facilities in New Jersey, Georgia, and Indiana, as well as a sales office in New York.

Visit MarinoWARE.com to experience our full line of innovative solutions.

For more information, please contact Marino\WARE[®] Technical Services at 866.545.1545

This technical information reflects the most current information available and supersedes any and all previous publications effective February 26, 2026 | MW Fire & Sound Installation Guide | © WARE Industries, Inc. 2026

Marino\WARE[®] operates state-of-the-art production facilities in New Jersey, Georgia, and Indiana, as well as a sales office in New York.

New Jersey Facility
400 Metuchen Road
South Plainfield, NJ 07080
800.627.4661
908.757.9000
Fax: 908.412.1442

Georgia Facility
777 Greenbelt Parkway
Griffin, GA 30223
800.504.8199
678.688.1312
Fax: 678.688.1379

Indiana Facility
4245 Railroad Avenue
East Chicago, IN 46312
866.636.6002
219.378.7100
Fax: 219.378.7106

New York Sales Office
51 John St. Ste. 1
Babylon, NY 11702
800.627.4667
631.691.2200
Fax: 631.691.1492

Marino\WARE[®] DesignGroup™
100 Hendrick Drive, Suite
200
McDonough, GA 30253
866.545.1545
678.688.7780
Fax: 770.507.2605